

- Electrically isolated
- Pull force – 5kg nom.
- -70°C to +200°C range
- 10/32UNF tapped hole
- 21mm Across flats
- 6.2mm height
- Low mass – 15gm

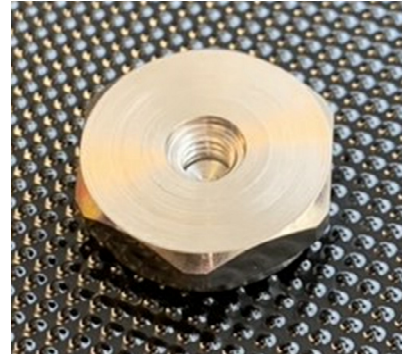

The KMMAG-21 is an isolated magnetic mounting base for use with accelerometers and other sensors requiring surface mounting. It features a nickel plated mild steel body and a PTFE isolating washer. This solution solves issues of earth loops causing interference in data signals from sensors.

Kemo can supply a range of adaptor studs for use with the KMMAG-21 making it flexible for use with a wide range of different manufacturer sensors

KMS-1028 - 1/4-28UNF thread  
KMS-10M6 – M6 thread  
KMS-10M5 – M5 thread  
KMS-1010S – 10/32UNF thread  
KMS-1054 – 5-40UNC thread

**Note:**

When using magnetic mounts with dynamic devices such as accelerometers, careful consideration should be applied to the type of surface finish on the test item, it is critical a smooth surface is present to avoid chattering of the magnet which will cause noise and data errors.

10/32UNF tapped hole,

4.4mm deep

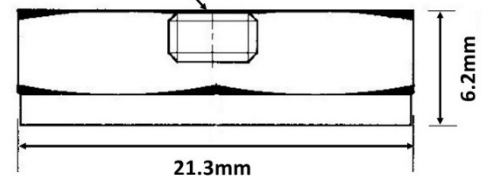

**Materials List:**

**Body:** Mild steel nickel plated

**Insulator:** PTFE

**Magnet:** Nickel plated Neodymium Iron Boron

**Pull Force:** 5kg nom.

**Mounting Torque:** 1.2Nm

Due to continued product development Kemo Limited reserve the right to change specification without notice.

**Kemo Limited**

First Floor, 33 King Street, Thetford, Norfolk, IP24 2AW, United Kingdom

+44 (0)1474 705168

[www.kemo.com](http://www.kemo.com) [sales@kemo.com](mailto:sales@kemo.com)